

**WHEN THE CEILING GRID PASSES OVER THE WALL
SINGLE LAYER STONE WOOL PLENUM BARRIER**

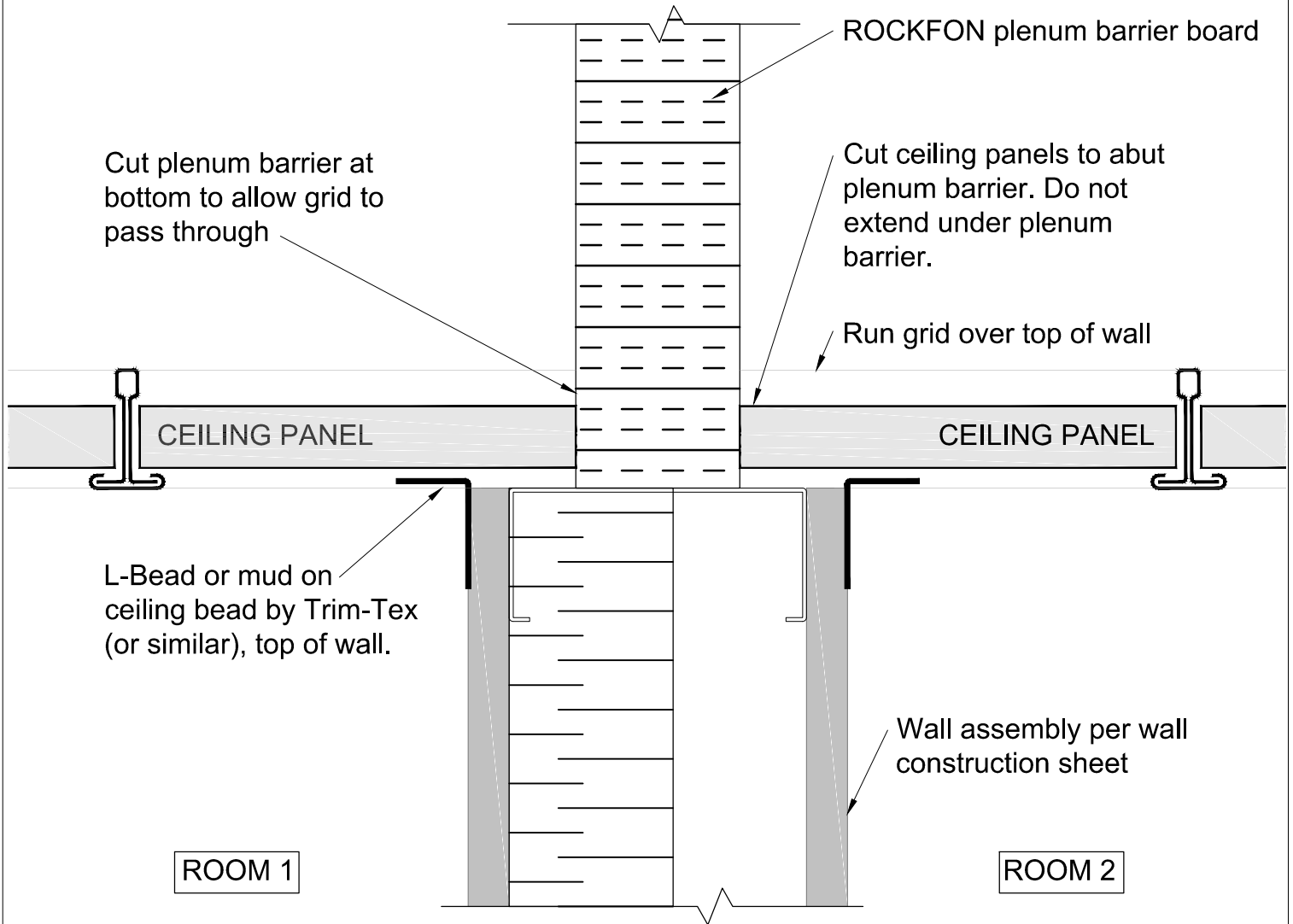

Rockfon[®]
Part of the ROCKWOOL GROUP

4849 South Austin Avenue
Chicago, IL 60638
www.rockfon.com

Toll Free: (800) 323-7164 (prompt #2)
Fax: (708) 563-4214
techservices@rockfon.com

Stone Wool Plenum Barrier
Continuous GRID STC 40

ORIG. DWG. DATE: 7/22/2017

DWG. BY: JLS

APPROVAL: _____

REV.:
REV. DATE:
SCALE: 6" = 1'-0"
DWG. NO.: STC 40 CG