

Rockfon® Spanair® Torsion Spring Plus Panel System

Features & Benefits

- Large scale concealed system allows for downward accessibility of panels without disturbing panel alignment.
- Standard sizes for Torsion Spring are 4' x 4', 4' x 6', 4' x 8' and 4' x 10'.
- Panels are reinforced for best finished appearance.
- Torsion Spring Plus panels are available in Standard and Painted finishes.
- For use in all seismic design categories.

Applications

- Airports
- Passenger Terminals
- Corridors
- Assembly Halls
- Convention Centers
- Stadiums



Project – Quinnipiac University, School of Law Center, North Haven, CT
Product – Rockfon® Spanair® Torsion Plus Spring Panels

Rockfon® Spanair® Torsion Spring Plus Panel System

LEED® v4.1 Highlights

Materials and Resources (MR)

Waste Management Planning	✓
Interiors Life Cycle Impact Reduction	✓
Environmental Product Declarations	✓
Sourcing of Raw Materials	✓
Material Ingredients	–
Waste Management	✓

Indoor Environmental Quality (EQ)

Low-Emitting Materials	✓
Interior Lighting	–
Acoustic Performance	✓

Recycled Content: 78% Aluminum
30% Steel

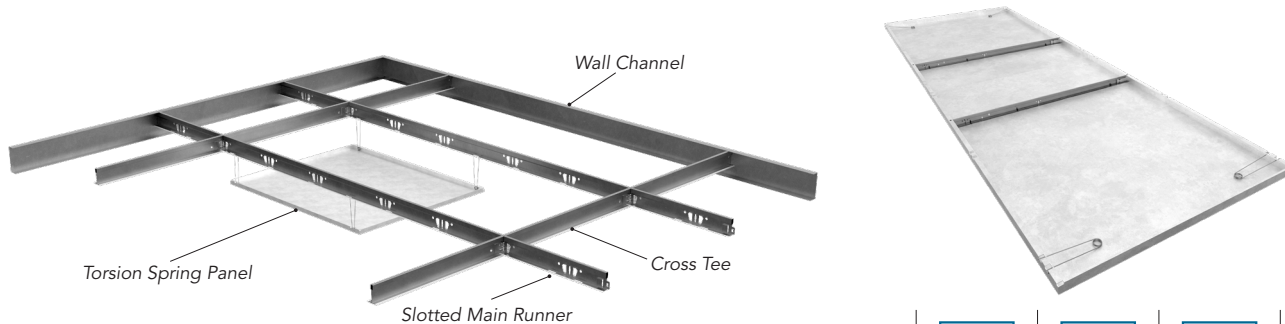

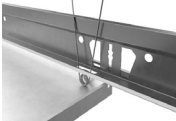
Family Number & Name	Edge Type	Dimensions		Perforations* (% Open Area)	Material	NRC	Fire Class	Low VOC	Recycled Content
		Width (w)	Length(l)						
252589:SPAN: Spanair® Metal Panel	STPL: Torsion Spring Plus Panel  Interior 1-11/16" Deep	up to 48"	(w) x 30: 30" (w) x 48: 48" (w) x 72: 72" (w) x 96: 96" (w) x 120: 120"	AA: 2.5% Z: 4.9%	.40AL: 0.040" Aluminum	up to 0.90***	A	✓	78%

Product Code Example:

252589:SPAN:STPL:48x72:.40AL:Z:44:Y

Family Number & Name: 252589 Spanair® Metal Panel Size: 48x72 Perforation: .40AL Acoutex: Yes or No: Y

Edge Type: Torsion Spring Material: 0.040" Aluminum Color: Satin Silver

Rockfon® Spanair® Torsion Spring Panels are approved for use in all Seismic Design Categories.

Custom panel sizes available – Contact Rockfon® for information

- * See the Rockfon Perforations Brochure for graphic representations of the perforations listed and the complete offering of Premium Perforations available.
- ** For designer specified Perforation, contact Rockfon Technical Services at 1-800-323-7164 or techservices@rockfon.com.
- *** NRC values are dependent on perforation patterns, plenum depth and acoustical backer options. Contact Rockfon Technical Services for more information at 1-800-323-7164 or techservices@rockfon.com.
- See color chart footnote for more information.

Note :

- Acoutex™ Backer standard with perforated panel.
- Perforated panel available without Acoutex.
- This system is not approved for exterior use.

Rockfon® Spanair® Torsion Spring Plus Panel System

Color Chart





Standard Colors

			
01 White	08 Black	44 Satin Silver	888 Winchester Gray



Other Painted Colors

						
Color-All	RAL Colors	Custom Colors	795 Champagne Metallic	796 Beige Metallic	797 Iron Glimmer Metallic	798 Copper Metallic

Woodlands™ Solid Coordinating Colors

			
450 Canyon Walnut	451 Nordic Oak	452 Desert Pine	453 Mountain Ashwood

Metalwood® Solid Coordinating Colors

					
401 Maple	402 Oak	403 Cherry	404 Pumpkin Maple	405 Karri	406 Walnut
					
457 Coastal Walnut	460 Honey Oak	462 Natural Walnut			

Colors shown are reproduced as close as possible to actual product color within the limitations of printing technology. Color chips are available upon request and should be reviewed before making a final selection. Variations in color matches of system components to ceiling panels can result from slight differences in texture, room lighting, painting process and subjectivity of observers.

As stated in CISCA's "Metal Ceilings Technical Guidelines," site conditions can impact installed visual appearance of metal ceilings. Usage of high gloss and metallic finishes in areas of critical lighting may alter final appearance and should be considered for finish selection.

Rockfon® Spanair® Torsion Spring Plus Panel System

Perforation Options

Standard Perforation

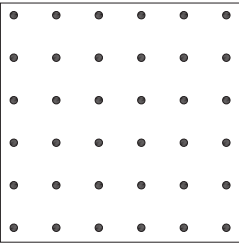

AA
62R354L
 0.0625" Diameter Holes
 0.354" Straight Centers
 2.5% Open Area

Premium Perforation

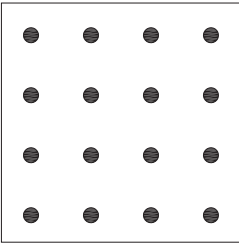

Z
125R500L
 0.125" Diameter Holes
 0.5" Straight Centers
 4.9% Open Area

Acoustical Performance



Spanair® Torsion Spring Plus Panels	Torsion Spring Plus Concealed Panels
NRC - Perforated with Acoutex™ Backer	0.70
NRC - Perforated with 1-1/2" Acoustical Pad	0.90

Rockfon® Spanair® Torsion Spring Plus Panel System

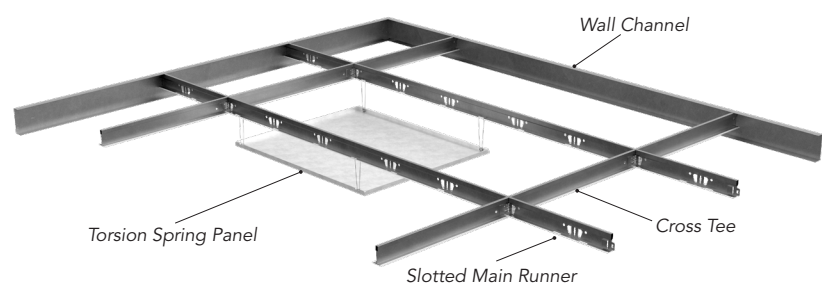
Suspension Components



Main Carriers 12'

Detail	Description	Catalog Number	Rockfon Part Number	Length	Height
Main Runners					
	HD Main runner 12' 8" O.C cross tee slots	10.00.400.000H	249388	12'	1-1/2"
	HD Main runner 12' 6" O.C cross tee slots	10.00.421.000H	258223	12'	1-1/2"
	HD Main Runner - 12' No Panel Slots* (For use with slotted cross tees)	10.00.400.000H	250252	12'	1-1/2"
Slotted Cross Tee					
	4' slotted cross tee for panel installation	10.00.424.000H	249389	4'	1-1/2"
Standard Cross Tees					
	Cross tee - 2'	10.00.412.001	250253	2'	1-1/2"
	Cross tee - 30"	10.00.412.902	315621	30"	1-1/2"
	Cross tee - 3'	10.00.413.001	258633	3'	1-1/2"
	Cross tee - 4'	10.00.414.001	250259	4'	1-1/2"
	Cross tee - 5'	10.00.415.001	250255	5'	1-1/2"
	Cross tee - 6'	10.00.416.001	250256	6'	1-1/2"
	Cross tee - 7'	10.00.417.001	250257	7'	1-1/2"
	Cross tee - 8'	10.00.418.001	250258	8'	1-1/2"

Rockfon® Spanair® Torsion Spring Plus Panel System

Perimeter Components

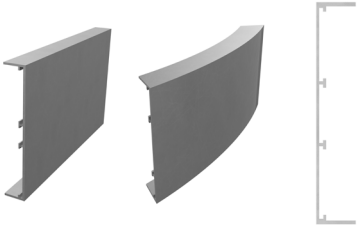
Detail	Description	Catalog Number	Length	Dimensions
Wall Channel				
	Spanair Wall Channel 10' for 1-11/16" deep panels	60.00.007.xxx	10'	1.5" x 1-21/32" x 15/16"
Infinity™ Perimeter Trim				
	Engineered Straight	252565 INFE:STD	12' Max	Height 6", 8" 10" or 12" length based on project requirements
	Engineered Curved	252566 INFC:STD	12' Max	Height 6", 8" 10" or 12" length based on project requirements

Wall Angle and Wall Channel available in Standard Painted, Premium Painted, and Woodscenes® finishes.

Infinity Perimeter trim available in Standard Painted, Premium Painted and Woodscenes finishes.

See the Infinity Data Sheet for additional information on Infinity Perimeter Trim.

Rockfon® Spanair® Torsion Spring Plus Panel System

Accessories



Hold Down Inserts

Description	Catalog Number	Rockfon Material Number	Length	Material
Hold Down Insert for Torsion Spring Plus Panels	60.00.035	253022	21.5"	Aluminum
	60.00.037	252236	45.5"	Aluminum

Acoustical Pads – Black Vinyl Wrapped

Description	Catalog Number	Rockfon Reference Number
2' x 2' - 1" x 1#	58.01.059.008	250505
2' x 4' - 1" x 1#	58.01.061.008	250507
2' x 2' 1.5" x 1#	58.01.064.008	250509
2' x 4' - 1.5" x 1#	58.01.063.008	250508

Other Accessories



Infinity Attachment Clip
448.9xx
Sized per Project



Perimeter Clip
1499.00
#251952

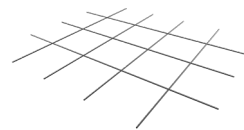

Wire Grid Spacer
60.00.021
#250526
*for use with
Acoustical Pad*

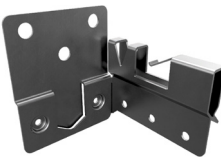

Seismic Perimeter Clip
1496.00
#250374

Rockfon® Spanair® Torsion Spring Plus Panel System

Properties

Material

0.040" Aluminum



Fire Performance

Surface burning characteristics:
UL723 (ASTM E84) Flame Spread Index: 0
Smoke Developed Index (UL Labeled): 0



Environment

Aluminum: 78% recycled content
Steel: 30% recycled content
100% locally recyclable



Hygiene

Metal provides no sustenance
to microorganisms



Cleaning

✓ Damp cloth



Warranty

1-Year Limited Product Warranty
See rockfon.com

070924

Rockfon

4849 S. Austin Ave.
Chicago, IL 60638 USA

Tel. +1-800-323-7164
cs@rockfon.com
rockfon.com