

Rockfon® Metal Panels and Planks

Planostile™ Lay-in Reveal, Flush Reveal, and Square
Planostile™ Snap-in
Planostile™ D
Spanair® Hook-in and Hook-on Plank
Spanair® Torsion
Spanair® Clip-in

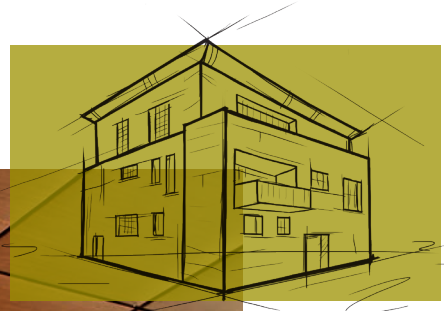

Project – University of South Carolina Williams-Brice Stadium in Columbia, SC
Product – Rockfon Planostile Metal Panels in 654R-Karri

Rockfon Metal Panels and Planks Ceiling Applications

Rockfon Planostile and Spanair panels offer design flexibility for wide-ranging interior and exterior applications. The panels come in a variety of sizes, profiles, materials, and finishes. When combined with companion perimeter trim and accessories, Planostile and Spanair panels can meet virtually any design need.

Additional features and benefits:

- Various finishes for any environment, both interior and exterior
- Painted colors, reflective coatings, wood-look veneer and vinyl wood finishes
- Metal contains no organic compounds to support mold and microbial growth
- Certain systems are seismically approved for C, D, E, and F installations

Ideal for:

- Transportation
- Education
- Retail
- Offices

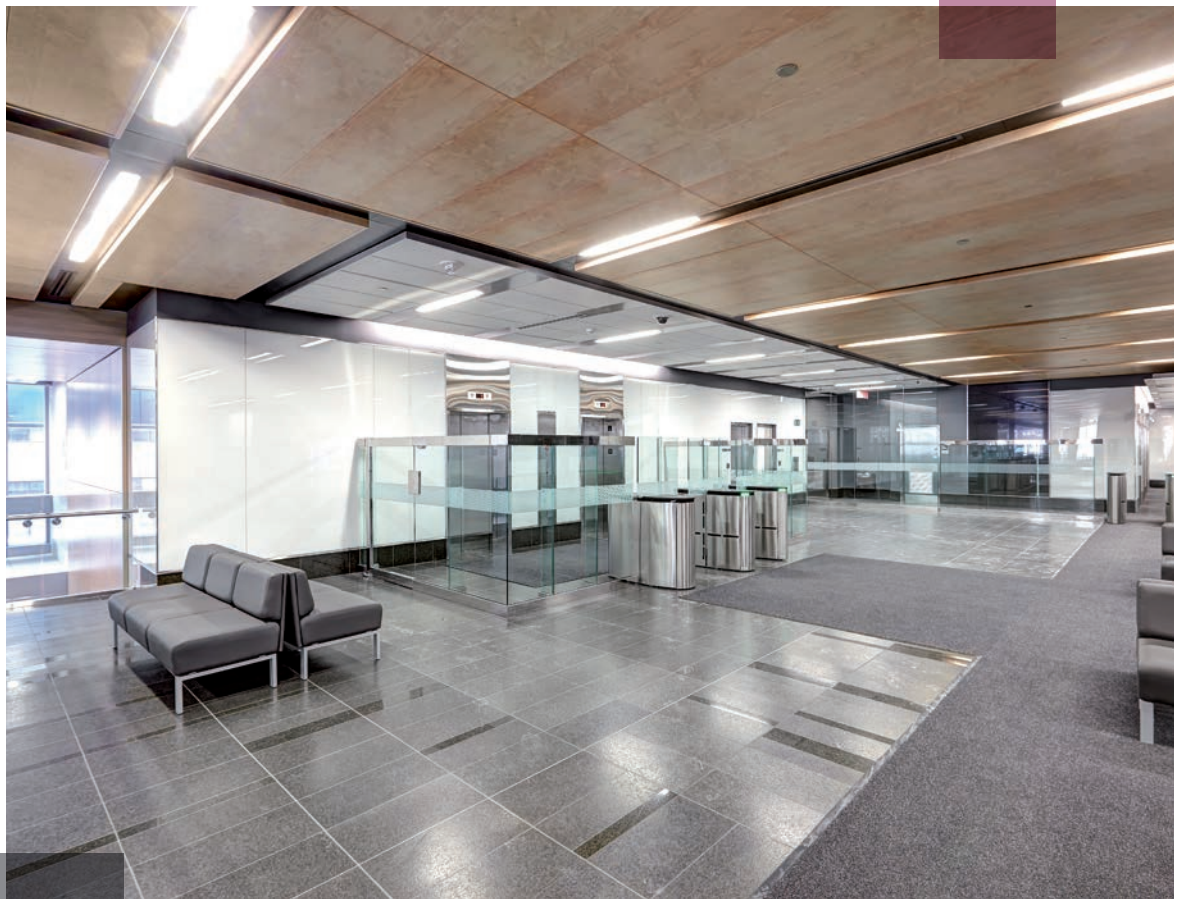

Project – 90 Elgin in Ottawa, Ontario
Product – Rockfon Spanair Hook-on Planks

Rockfon Planostile and Spanair Success Stories

Rockfon Planostile Metal Panels Dramatically Improve Subway Station

Approximately 41,000 arrive and depart from Islington Subway Station, part of the Greater Toronto Area transit system, every day. To update their 13,000 square-foot location, they chose Rockfon Planostile Lay-In panels in a Satin Silver finish. "Aesthetically, we were aiming for clean lines and tight joints between the panels to result in a seamless looking ceiling," notes John Amaral, senior designer with TTC's Plant Maintenance Department - Engineering. By using Rockfon Planostile panels, the subway station received not only an updated look but a sustainable choice with a product that is 100% recyclable at end of life.



Rockfon Spanair Ceiling System Delivers "Wow Factor" at Florida's Manatee Technical Institute

Serving nearly 1,000 students in Florida's Sarasota/Bradenton area, the new Manatee Technical Institute (MTI) Main Campus building represents a modern, high-tech training facility to meet the workforce needs of the 21st Century. Rockfon Spanair Hook-in and Hook-on metal planks in a Satin Silver finish were used to accentuate the ceiling's high-end look. The high recycled content value was an important part of the product selection process, as LEED standards guided the building's design.

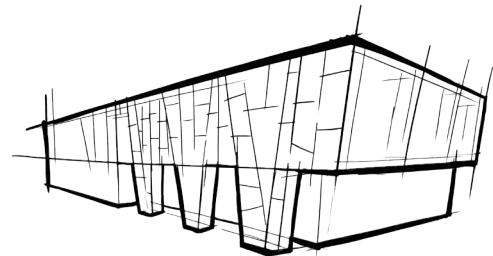

A Ceiling Design to Fit Your Need

With Rockfon metal panels and planks you can achieve a wide range of design aesthetics. Highlight the clean lines with one of our products that works with an exposed grid system, or create a smooth ceiling expanse with a product that conceals the suspension. Expand your ceiling design possibilities with Rockfon metal panels and planks.

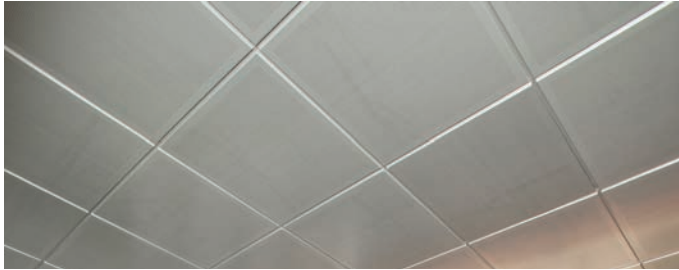

Rockfon Planostile Lay-In panels expose the grid system, creating a distinct, linear look.





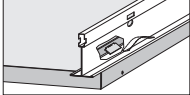
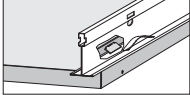
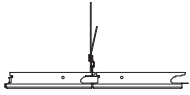
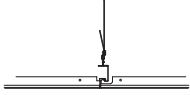
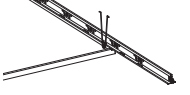
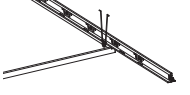

Rockfon Spanair Torsion Spring planks eliminate the appearance of the grid system, focusing instead on the panel's design.

Product Detail	Dimensions	Perforations
Spanair® Clip-in Metal Panel Fully Concealed 	24" x 24" 24" x 48" Custom*	Standard: D, E, R, V, J, Q, AA Premium: B, F, G, H, I, K, L, N, O, P, W, Y, Z, AB, AC, AD, AE, AF, AG, AH, AI, AJ, AK
Spanair® Clip-in Metal Panel Semi-Concealed 	24" x 24" 24" x 48" Custom*	Standard: D, E, R, V, J, Q, AA Premium: B, F, G, H, I, K, L, N, O, P, W, Y, Z, AB, AC, AD, AE, AF, AG, AH, AI, AJ, AK
Spanair® Hook-in Metal Panel Square Edge 	Widths: 12" or 24" Lengths: 48", 60", 72", 84", 96"	Standard: D, E, R, V, J, Q, AA Premium: B, F, G, H, I, K, L, N, O, P, W, Y, Z, AB, AC, AD, AE, AF, AG, AH, AI, AJ, AK
Spanair® Hook-on Metal Panel Square Edge 	Width Range: 9"-24" Length range: 48"-120" Custom*	Standard: D, E, R, V, J, Q, AA Premium: B, F, G, H, I, K, L, N, O, P, W, Y, Z, AB, AC, AD, AE, AF, AG, AH, AI, AJ, AK
Spanair® Torsion Spring Concealed Metal Panel** 	24" x 24" 24" x 48" Custom***	Standard: D, E, R, V, J, Q, AA Premium: B, F, G, H, I, K, L, N, O, P, W, Y, Z, AB, AC, AD, AE, AF, AG, AH, AI, AJ, AK
Spanair® Torsion Spring Plus Concealed Metal Panel 	Width Range: 24"-48" Length range: 24"-120" Custom***	Standard: AA Premium: Z

* For custom options, please contact Rockfon Technical Services at ts@rockfon.com.

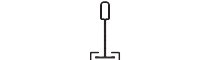
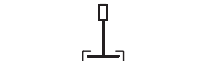
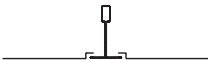
** For more information on specialized, exterior Torsion Spring products, please contact Technical Services at ts@rockfon.com

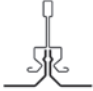
*** Panels can be as small as 10" wide. For more information please contact Technical Services at ts@rockfon.com

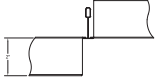
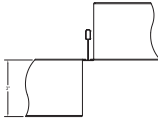
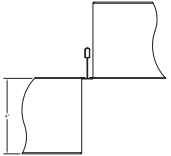
Product Detail	Dimensions	Perforations
Planostile™ Lay-in Square Edge 	24" x 24" 24" x 48" Custom	Standard: D, E, R, V, J, Q, AA Premium: B, F, G, H, I, K, L, N, O, P, W, Y, Z, AB, AC, AD, AE, AF, AG, AH, AI, AJ, AK
Planostile™ Lay-in Reveal Edge 9/16" 	24" x 24" 24" x 48" Custom	Standard: D, E, R, V, J, Q, AA Premium: B, F, G, H, I, K, L, N, O, P, W, Y, Z, AB, AC, AD, AE, AF, AG, AH, AI, AJ, AK
Planostile™ Lay-in Reveal Edge 15/16" 	24" x 24" 24" x 48" Custom	Standard: D, E, R, V, J, Q, AA Premium: B, F, G, H, I, K, L, N, O, P, W, Y, Z, AB, AC, AD, AE, AF, AG, AH, AI, AJ, AK
Planostile™ Lay-in Flush Reveal Edge 	24" x 24"	Standard: D, E, R, V, J, Q, AA Premium: B, F, G, H, I, K, L, N, O, P, W, Y, Z, AB, AC, AD, AE, AF, AG, AH, AI, AJ, AK
Planostile™ Snap-in Square Edge 	24" x 24" 24" x 48" 20" x 60" Custom	Standard: D, E, R, V, J, Q, AA Premium: B, F, G, H, I, K, L, N, O, P, W, Y, Z, AB, AC, AD, AE, AF, AG, AH, AI, AJ, AK
Planostile™ Snap-in Bevel Edge 	24" x 24"	Standard: D, E, R, V, J, Q, AA Premium: B, F, G, H, I, K, L, N, O, P, W, Y, Z, AB, AC, AD, AE, AF, AG, AH, AI, AJ, AK
Planostile™ D 1" Reveal 	24" x 24"	Standard: E
Planostile™ D 2" Reveal 	24" x 24"	Standard: E
Planostile™ D 3" Reveal 	24" x 24"	Standard: E
Planostile™ D 4" Reveal 	24" x 24"	Standard: E



Project – Cranbrook Kingswood Middle School for Girls in Bloomfield Hills, MI
Product – Rockfon Spanair Hook-in Plank

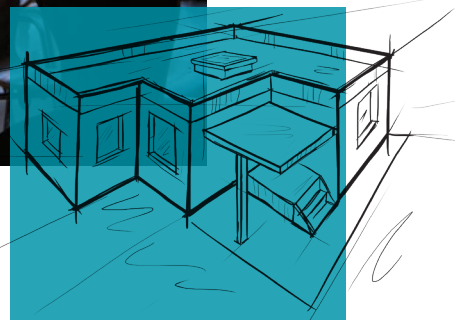

Rockfon Metal Ceiling Color Options

Standard Painted Colors

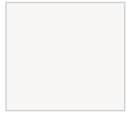

01
White



08
Black



44
Satin Silver



888
Winchester Grey

Woodscenes® Painted Colors*



800
Lazy Maple



803
Burnished Cherry



805
Weathered Oak



801
Aged Teak



804
Sleek Cherry



806
Barnwood Grey

Metalwood® Woodgrain Finishes**



650R
Maple♦



654R
Karri♦



402
Oak▲



406
Walnut▲

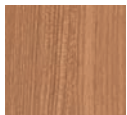

651R
Cherry♦



655R
Bamboo♦



403
Cherry▲



652R
Pumpkin Maple♦

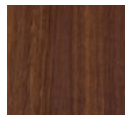

656R
Walnut♦



404
Pumpkin Maple▲

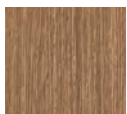

653R
Oak♦



401
Maple▲



405
Karri▲

Rockfon® Color-all™ Colors***

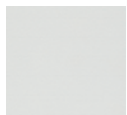

701
Stone



704
Mastic



707
Tarmac



721
Chalk



702
Plaster



705
Zinc



708
Anthracite



722
Linen

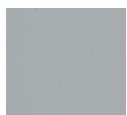

703
Gravel



706
Concrete













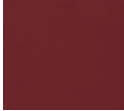

720
Stucco



723
Hemp

Rockfon® Color-all™ Colors*** (continued)

	724 Cork		742 Fresh		751 Curacao		771 Scarlet
	725 Earth		743 Breeze		752 Vitamin		772 Ermine
	726 Clay		744 Aqua		760 Copper		773 Emerald
	727 Humus		745 Misty		761 Gold		
	740 Light		746 Twilight		762 Mercury		
	741 Sunrise		750 Chili		770 Garnet		

* Not available in Rockfon Planostile D.

** Metalwood is not applicable for exterior installations. Metalwood is also not a option for Spanair Torsion Spring Plus panels or panels greater than 2' wide.

*** Premium Colors.

♦ Not available in Rockfon Infinity™, Curvgrid™, Planostile™ D or panels wider than 24". For interior use only.

▲ Coordinating solid color to match Metalwood Woodgrain Finishes.

Colors shown are reproduced as close as possible to actual product color within the limitations of printing technology. Color chips are available upon request and should be reviewed before making a final selection. Variations in color matches of system components to ceiling panels can result from slight differences in texture, room lighting, painting process and subjectivity of observers.

Can't Find the Color You're Looking for?

Rockfon offers a color-matching program for our Specialty Metal Ceilings solutions.



Project – Porsche of The Motor City in Eastpointe, MI
Product – Rockfon Spanair Clip-in Perforated Metal Ceilings Panels

Keeping Acoustics and Sustainability in Mind

Perforations for Optimized Acoustics

Rockfon perforation options are not only used for aesthetic purposes, but also can be used to improve the acoustical function of the product. Rockfon provides several perforation options that, when combined with an acoustical backer, can provide up to a 0.90 Noise Reduction Coefficient (NRC) rating. More information on perforation options for the Rockfon Planar product lines, and all other metal ceiling product lines, can be found in the Rockfon Perforation Brochure.

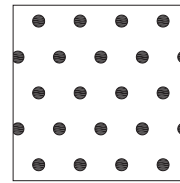

Perforation T

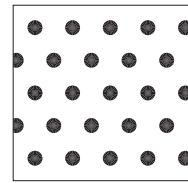

Perforation AL

Discover all of Rockfon's metal ceiling perforation options in our Perforation Brochure.

Metal Panel Acoustical Backer Additions

In addition to perforation options, Rockfon offers a variety of metal panel acoustical backers to add higher NRC value to each panel. Embodying the purpose of Optimized Acoustics, these panels' acoustical backers allow the panels to be beautiful as well as acoustically functional. For an NRC value of up to 0.75, Rockfon acoustical backer is a smooth, black felt that is applied to the back of the panel at time of manufacture. For an even greater NRC value of up to 0.90, glass fiber poly acoustical backers are a great option for those seeking an even higher acoustical absorption.

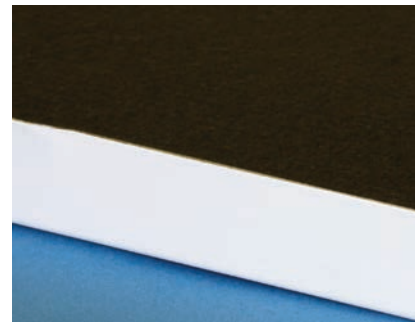

Aluminum = Better for the Environment and Your Wallet

Rockfon metal ceilings are primarily made with aluminum, which features an up to 90% recycled content rating. Aluminum also can be easily recycled at end of life using standard processing facilities. It is due to this sustainable material that Rockfon metal ceilings are the cost-effective alternative to real-wood ceilings. Designers can achieve a natural wood-look, but oftentimes at half the cost. Rockfon metal ceilings also contain no organic compounds, which does not contribute to mold or microbial growth.







Rockfon® is a registered trademark
of the ROCKWOOL Group.

2018 | Subject to alterations in range and product technology without prior notice. Rockfon accepts no responsibility for printing errors.
© ROCKWOOL International A/S 2018. All rights reserved. ® denotes a trademark that is registered in the United States of America.

Rockfon

4849 S. Austin Ave.
Chicago, IL 60638 USA

Tel. +1-800-323-7164
Fax. +1-800-222-3744
www.rockfon.com
360003005

